

SITKA
Fine Arts Camp

on the

**Sheldon Jackson
School National
Historic Landmark
Allen Hall Walkways**



*Richard H. Allen Memorial Hall ,
Historic American Buildings Survey - AK-105-A, 1996*

Rehabilitation

“Of the four treatments, only **Rehabilitation** includes an opportunity to make possible an efficient contemporary use through alterations and additions.”

The Secretary of the Interior’s Standards for the Treatment of Historic Properties



Early photo of quad, date unknown (c. 1910) – Sheldon Jackson College Archives

Ludlow and Peabody Plan 1910-1911

- ▶ Only formal campus plan in Alaska
- ▶ Craftsman and Western stick architectural elements
- ▶ Overlooks Sitka Sound (now Crescent Harbor)
- ▶ Buildings arranged around a central quadrangle

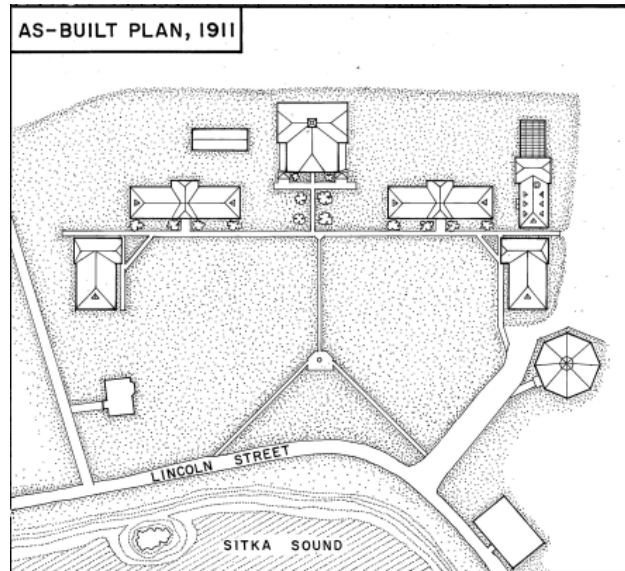
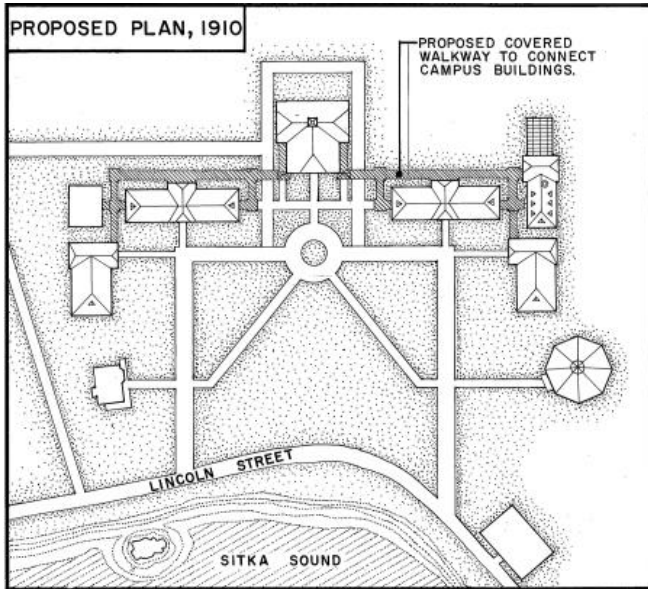

1912

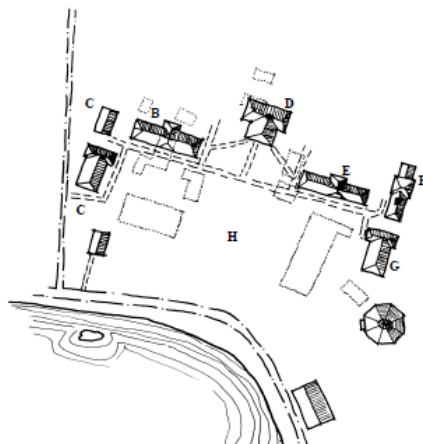

1920

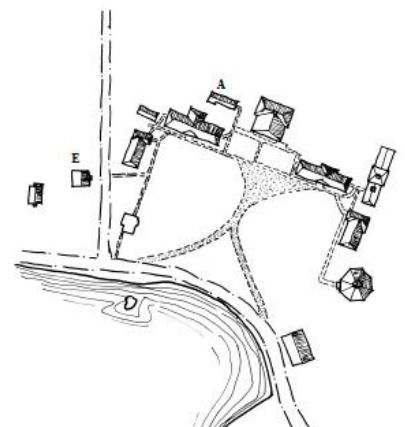

1930

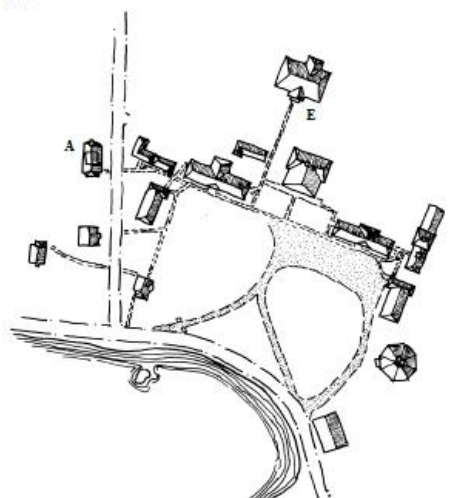

1960

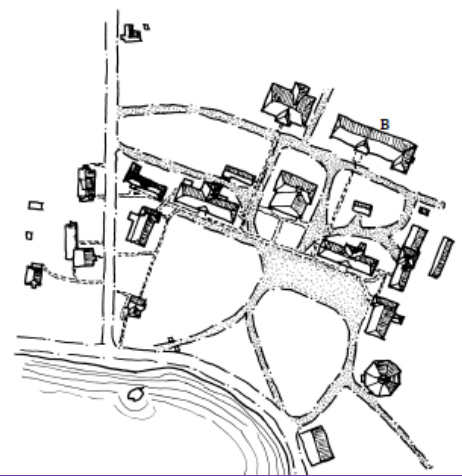

Pictorial History

*Sheldon Jackson School National Historic
Landmark Campus Preservation Plan, 2004*

Photographs – Landscape Transitions



Early photo of quad, date unknown (c. 1910) –
Sheldon Jackson College Archives

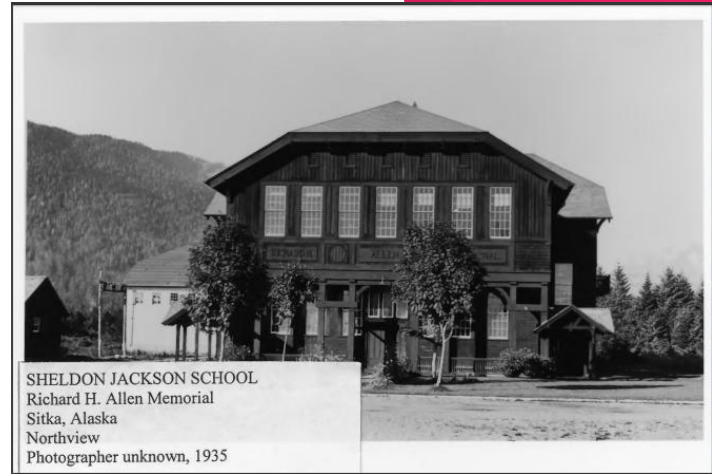

SHELDON JACKSON SCHOOL
Richard H. Allen Memorial
Sitka, Alaska
Northview
Photographer unknown, 1935



National Register of Historic Places Inventory-
Nomination, 2001

Utilities History

Various plans- 2000, 2003

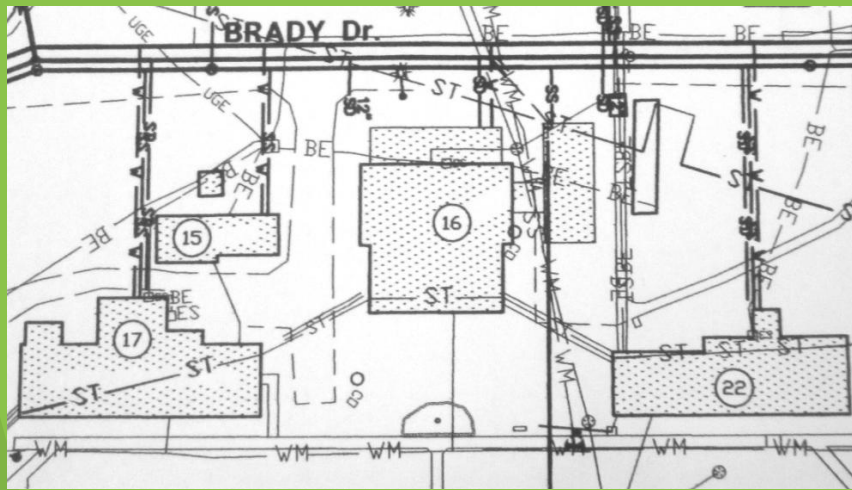

2000 Campus Utilities
(New Water, Stormdrain and Sewer as well as existing buried steamline, buried electric, underground electric)

2003 Campus Utilities
(Electric and communications)

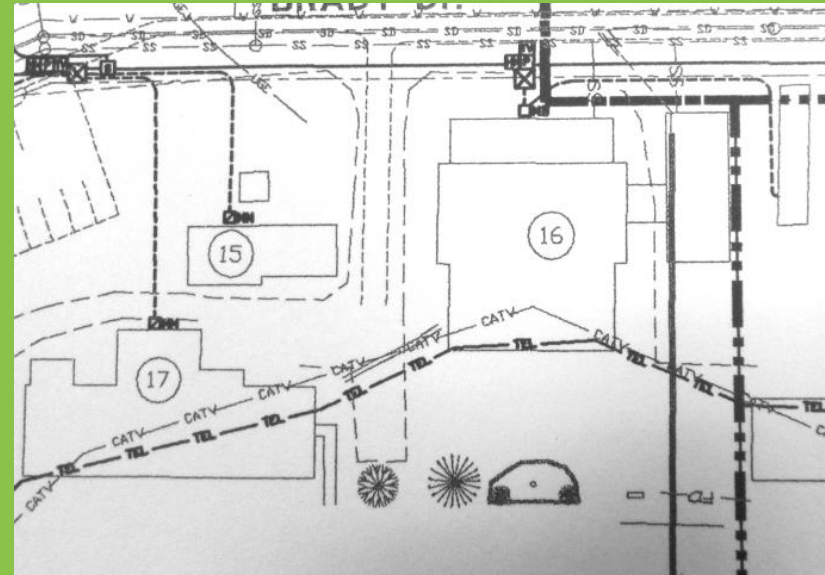

Character Defining Features

- A grade that slopes to the south
- An unobstructed view of Sitka Sound
- Axial symmetry with a focus on Allen Hall
- A forecourt south of Allen Hall

*Sheldon Jackson School National Historic Landmark
Campus Preservation Plan, 2004*

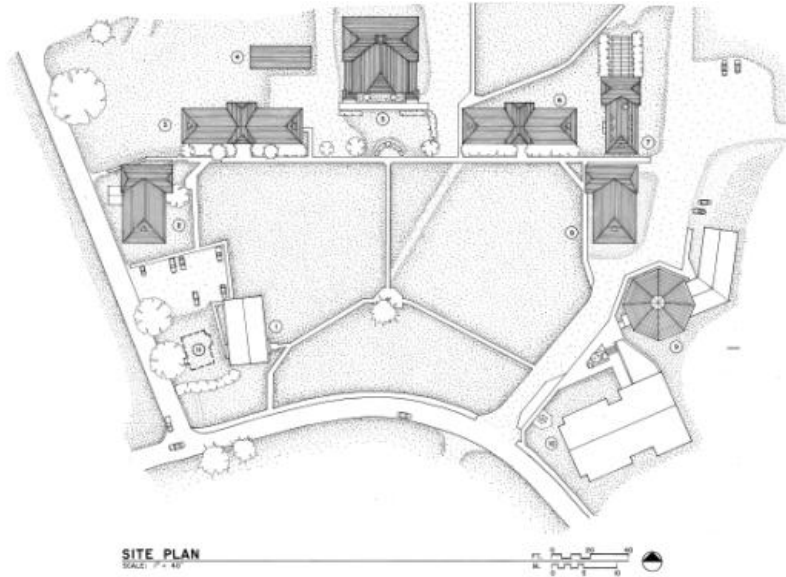

Richard H. Allen Memorial Hall - Historic American Buildings Survey - 1996



Photo by James Poulson, 2012

Design for replacement of missing historic features

“

... A second acceptable option for the **replacement** feature is a new design that is compatible with the remaining character-defining features of the historic building.

The Secretary of the Interior's Standards for the Treatment of Historic Properties

Treatment Recommendations

- Re-establish the forecourt in front of Allen Hall as the focal point of access (remove bell and surrounding vegetation)
- Main approach to the campus from the south (through historic concrete entrance gates)
- Open spaces between the buildings should remain open (landscape with grass)
- Only shrubs should be planted around the buildings and should be placed in such a manner that they reinforce entry points to the buildings.



*Sheldon Jackson School National Historic Landmark
Campus Preservation Plan, 2004*

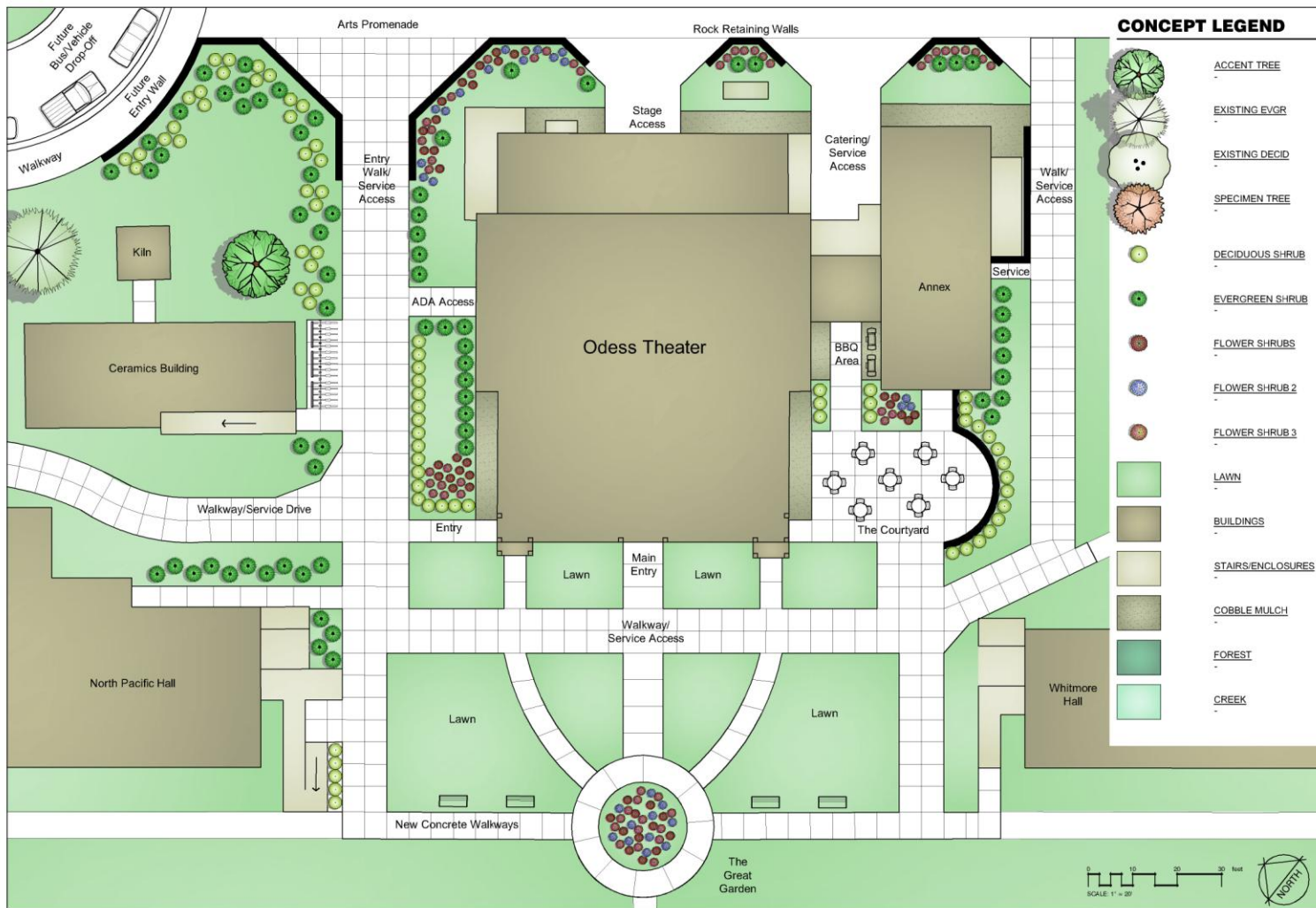

CONCEPT LEGEND

- ACCENT TREE
- EXISTING EVGR
- EXISTING DECID
- SPECIMEN TREE
- DECIDUOUS SHRUB
- EVERGREEN SHRUB
- FLOWER SHRUBS
- FLOWER SHRUB 2
- FLOWER SHRUB 3
- LAWN
- BUILDINGS
- STAIRS/ENCLOSURES
- COBBLE MULCH
- FOREST
- CREEK

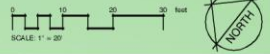

ANDERSON LAND PLANNING
Landscape Architecture

MONIQUE ANDERSON
Landscape Architect
ANDERSON LAND PLANNING
473 Karlov Street, #151A
Sitka, AK 99801 : 907.230.8003

PROJECT:
Sitka Fine Arts Camp at Sheldon Jackson College
Odess Theater Walkways Concept
DATE: 1/4/16

Walkways
Concept



Lighting

Nighttime safe access to the building site is a priority.

There is also opportunity for accent lighting on the building.

Designer: Anderson Shirley Architects, Oregon

Bell and Plaque

Appropriate display location for the bell and plaque



Flagpole

A flagpole was removed but there is a desire to add a ceremonial flagpole to the site.

THANKS!

Any questions?

You can find me at
andersonlandplanning@gmail.com